

Knowledge Organiser



The Memphis Design Movement



Looking at the work of others. The Memphis design movement. looking at the work of Ettore Sottsass

Using the 5 rules of Memphis. Bold Shapes, Patterned Surfaces, Odd angles, bright colours and quirkiness to apply to your designing.



Plastics Theory work

Thermoplastics
Thermosetting Plastics
Environmental issues



Solvents and how they work. Using a solvent to fuse a piece of plastic together. Health and Safety considerations including Risk Assessments and COSHH.



Using abrasives to get the edges smooth ending in a shiny finish.

- 1 – Cross filing
- 2 – Draw filing
- 3 – 80 Grit
- 4 – 120 Grit
- 5 – 320 Grit
- 6 - 400 Grit
- 7 - Buffing



Buffer

Memphis Clock

Evaluating Existing Products

As a design strategy looking at existing products and evaluate them in terms of aesthetics and function. The combination of 'Form' and 'Function' and the understanding that there is a compromise between the two.



Looking at Design Fixation and stereotypical application of ideas. How To avoid these Traits to design Original Memphis clocks

Using a range of design strategies producing a set of design ideas that follow the Memphis Clock Specification

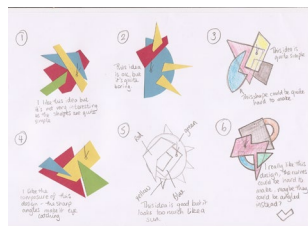

Design ideas will be evaluated to a high standard against the Memphis criteria.

Colouring Pencils

A final idea is chosen which will be fully justified. A final design is chosen and planning for making will be detailed.

Completing the clock

Using a pillar drill to drill a hole through the acrylic plastic in order to fit the clock movement. Special drill bits used to prevent the corkscrew effect as the drill breaks through the acrylic



Using the correct tools to assemble the clock movement and set the correct time.

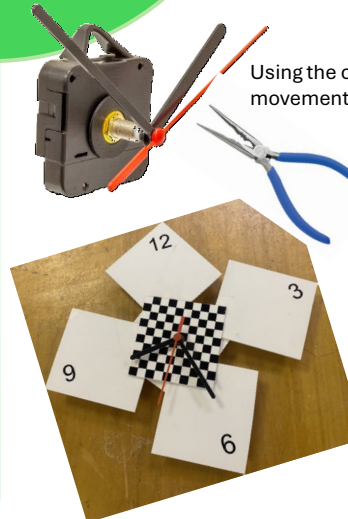

Finished clocks



Literacy - Food Safety & Personal Hygiene (Year 10)

Tier 2 Vocabulary

Tier 3 Vocabulary

Accurate

Getting as close to your intended line as possible.

Deciduous

A hardwood tree. One that drops it's leaves in autumn

Rendering

Application of colour or a texture to a surface

Coniferous

A cone bearing softwood tree

Cutting

Separating or removing material

Grain

bacteria which cause disease (unsafe)

Smoothing

Making sure a surface is flat

Kerf

The thickness of a cut based on the blade width

Key word glossary

Speak like a Technologist

Rendering

Filing

When cutting

I have cut on the waste side of the line to then sand down to the line.

Clamping

Rasp

When finishing

I have applied 5 layers of wax to body up the finish

Drilling

Glass Hard

Rendering

I have used colouring pencils to create a sensitive and graduated effect by building up the layers.

Short / long grain

Finish

Drilling

I have drilled the holes safely by clamping the work securing and wearing my protective equipment.